



CLASS 5 TORQUE ANALYSER (CL5TA)

THE TOOL

The Class 5 Torque Tool Surface Calibration Unit (SCU) consists of a calibrated torque transducer mounted within an anodised aluminium body. The Class 5 Torque Tool Surface Calibration Unit fully replicates the reaction geometry of the subsea interface which is compatible with ISO 13628-8 Class 5 torque receptacle with a 2" square drive. Two handles are provided to aid handling.

The integral transducer is bi-directional, and has a nominal torque range of 0-7,000 Nm.

Power and signal connections to the transducer are via a Harsh Environment IP65 hand held meter, which is supplied with a suitable interconnecting cable. Clear torque values in clockwise and counter clockwise directions can be simply verified both before and after any given torque tool operation. The torque is displayed in a handheld Torque Readout Unit (TRU).

The SCU is supplied with a support plate. This plate allows the SCU to be secured horizontally to a workbench and places the tool at the optimal angle to facilitate filling, bleeding and maintenance. Securing of the SCU in this manner also facilitates certain assembly and disassembly processes. The plate is designed to be clamped to the bench at its outermost edges. Alternatively, the plate may be removed and receptacle mounted to the workbench directly using the fastening points provided.

There is no requirement to mount the SCU via the plate during calibration and the plate may be removed when not required.

The SCU is supplied in a separate transport box.

TECHNICAL SPECIFICATIONS

WEIGHTS & DIMS

- Equipment weight (in air): 39 kg (approx.)
- Equipment dimensions L x W x H: 396 x 500 x 240 mm
- Shipping weight: 70 kg (max.)
- Shipping dimensions L x W x H: 670 x 510 x 380mm

OTHER SPECIFICATIONS

- Max. input Torque: 7,000 Nm
- Accuracy: +/- 2%
- ROV interface: ISO13628-8
- Depth rating: Surface use only



DATA SHEET ///
CL5TA





CLASS 5 TORQUE ANALYSER (CL5TA)

DRAWING

Critical dimensions are displayed below. Further details can be provided upon request.

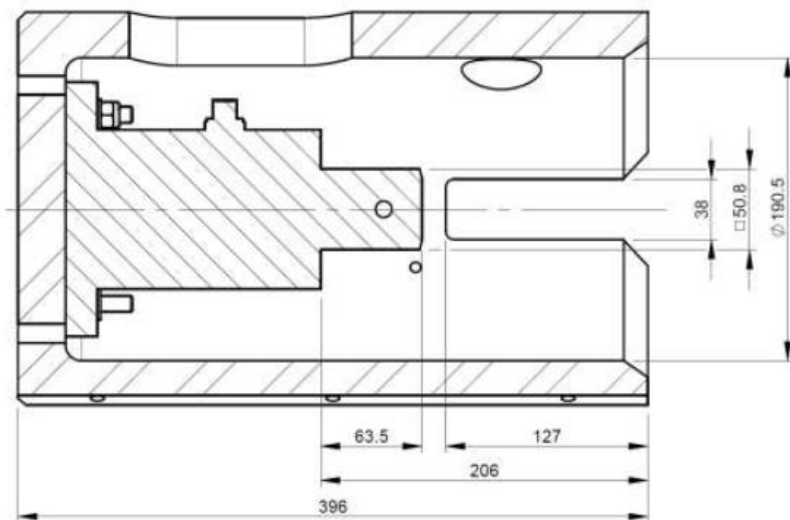

For more information contact Blakemere:

info@blakemere.com.au

+61 (08) 9373 1300

DATA SHEET ///
CL5TA

